

Couplings „STORZ“ aluminium forged

Advantage / benefit:.....forged version, very high sturdiness and break resistance
 Material:.....Aluminium
 Sealing:NBR black
 Operating pressure:max. 16 bar
 Please note:.....Industrial version, other dimensions and materials upon request

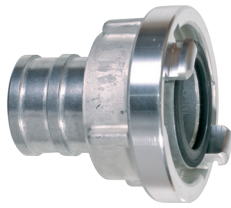

Suction couplings „STORZ“

Hose IW mm	13	19	25	32	38	45
Hose size	1/2"	3/4"	1"	1 1/4"	1 1/2"	1 3/4"
Cleat distance mm	31	31	31	66	66	66
STORZ size	25-D	25-D	25-D	52-C	52-C	52-C
PU units	1	1	1	1	1	1
Catalogue no.	D102513	D102519	D102525	C105232	C105238	C105245
EDV no.	69.0001	69.0002	69.0003	69.0004	69.0005	69.0006

Hose IW mm	52	65	75	100	125	150
Hose size	2"	2 1/2"	3"	4"	5"	6"
Cleat distance mm	66	89	89	133	148	160
STORZ size	52-C	75-B	75-B	110-A	125	150
PU units	1	1	1	1	1	1
Catalogue no.	C105250	B107563	B107575	A10100	A10125	A10150
EDV no.	69.0007	69.0008	69.0009	69.0010	69.0011	69.0012



Suction couplings „STORZ“ with edge

Hose IW mm	50	75	100
Hose size	2"	3"	4"
Cleat distance mm	66	89	133
STORZ size	52-C	75-B	110-A
PU units	1	1	1
Catalogue no.	C205250	B207575	A20100
EDV no.	69.0013	69.0014	69.0015

7

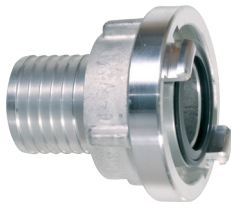

Suction couplings „STORZ“ with ribbed grommet profile

Hose IW mm	51	76	102
Hose size	2"	3"	4"
Cleat distance mm	66	89	133
STORZ size	52-C	75-B	110-A
PU units	1	1	1
Catalogue no.	C305250	B307575	A30100
EDV no.	69.0016	69.0017	69.0018



Fixed couplings „STORZ“ with female thread

Female thread mm	19,17	24,66	30,93	39,59	45,48	51,43	57,29
Female thread	G 1/2"	G 3/4"	G 1"	G 1 1/4"	G 1 1/2"	G 1 3/4"	G 2"
Cleat distance mm	31	31	31	66	66	66	66
STORZ size	25-D	25-D	25-D	52-C	52-C	52-C	52-C
PU units	1	1	1	1	1	1	1
Catalogue no.	D402510	D402511	D402513	C405214	C405216	C405218	C405219
EDV no.	69.0019	69.0020	69.0021	69.0022	69.0023	69.0024	69.0025

Female thread mm	72,86	72,86	85,56	110,71	135,95	161,50
Female thread	G 2 1/2"	G 2 1/2"	G 3"	G 4"	G 5"	G 6"
Cleat distance mm	66	89	89	133	148	160
STORZ size	52-C	75-B	75-B	110-A	125	150
PU units	1	1	1	1	1	1
Catalogue no.	C405225	B407525	B407530	A401004	A401255	A401506
EDV no.	69.0026	69.0027	69.0028	69.0029	69.0030	69.0031